

# INDUSTRIAL FANS



**BK AIR**  
FRESH AIR SOLUTION FOR LIFE



The leader in industrial fans

# Centrifugal Blowers



# Product detail

BKAIR offers different type of centrifugal blowers depending upon the application. BKAIR has a team of trained engineers and is capable in designing, supply, erection and commissioning of HVAC (Humidification, Ventilation and Air Conditioning) systems. BKAIR always believes in quality control, better performance and timely delivery. BKAIR centrifugal blowers are highly efficient and heavy duty, therefore BKAIR centrifugal blowers are in great demand. BKAIR centrifugal blowers have a wide range of applications in different type of industries such as automotive, foundries, power plants, chemical plants etc.



Backward curved Blower Arrangement-B



Limit Load Blower (LLD) Arrangement-D



Backward curved Blower Arrangement-A



Forward curved Blower Arrangement-D

BKAIR centrifugal blowers have four types of driving arrangements:-

- 1) Arrangement A :- Impeller is directly mounted on the motor shaft.
- 2) Arrangement B :- Impeller is directly mounted on a shaft and shaft is supported by two bearings enclosed in plummer block placed on a pedestal in one side of the Fan.
- 3) Arrangement C :- Impeller is directly mounted on a shaft and the shaft is supported by two bearings enclosed in plummer block placed on extended pedestal in one side of the Fan. The shaft is directly coupled with a coupling.
- 4) Arrangement D :- Impeller is placed in between a shaft which is placed on the bearings enclosed in plummer block on each side of the Fan.



Backward curved Blower Arrangement-C

The housing of BKAIR centrifugal blowers is made from M.S, S.S. and Carbon Steel according to the requirement and is completely welded construction. Blowers with FRP lined can also be offered where necessary.

The impellers are of multi bladed construction for smooth vibration free running. All impellers are statically and dynamically balanced. BKAIR has different types of impeller arrangements to suit different applications.



Backward Curved Self Cleaning Blades



Limit Load Blades



Backward Curved Blades



Forward curved Blades

BKAIR centrifugal blowers are manufactured with air capacity of 300 CMH to 2,00,000 CMH and pressure upto 1200 mmwg.

BKAIR has LLD (DIDW) type blowers for low pressure, low noise level and high volume. These blowers have forward cum backward type blades and the BHP consumption for particular RPM is limited at different pressure and therefore called Limit Load. These blowers are heavy duty and can be used in Air cooling, Air conditioning, Ventilation and Pressurization purpose etc.

BKAIR ID and FD fans are manufactured in heavy duty construction and have statically and dynamically balanced impellers which provides smooth and vibration free performance. These fans are made with the capacity of 500 CMH to 1,50,000 CMH. These Fans have completely backward curved, backward curved self cleaning and straight radial blades.

## BKAIR CENTRIFUGAL BLOWERS-MAX. STATIC PRESSURE RANGE

Type	Total Pressure mmWG	Type	Total Pressure mmWG	Type	Total Pressure mmWG	Type	Total Pressure mmWG
BKMRL	300	BKMRM	600	BKHRM	900	BKLLD/S	upto 375
BKCBL	130	BKMBM	450	BKHBM	800		
BKMSL	250	BKMSM	400	BKHBH	1200		

To enable us to select the right fan for your requirement, let us know the following information:-

- ➔ Application
- ➔ Temperature
- ➔ Static Pressure
- ➔ Gas Flow

# AXIAL FLOW FAN

**BKAIR** offers a most economical and efficient range of Axial Flow Fans For the industry such as thermal power, fertilizers, heavy engineering, textile, food, general purpose, pharmaceuticals etc. for providing General ventilation fume exhaust and removal of hot spots.

BKAIR axial fans can also be used as roof extractor fans.

**BKAIR** axial flow fans are manufactured for all applications and mounting arrangements.

The available sizes are from dia 400 to 1600 mm diameter.

The air volume range is from 1000 to 15000 m<sup>3</sup>/h, and static pressure up to 150mmWG.

DIMENSION TABLE				
BKA	ØD1	T	ØD	L
400	469	6	400	310
450	419	6	450	350
500	569	6	500	350
550	619	6	550	390
600	685	6	600	430
700	785	6	700	440
800	885	6	800	560
900	985	6	900	575
1000	1105	10	1000	590
1200	1305	10	1200	680
1300	1405	10	1300	760
1400	1505	10	1400	760
1500	1605	10	1500	760
1600	1706	10	1600	800

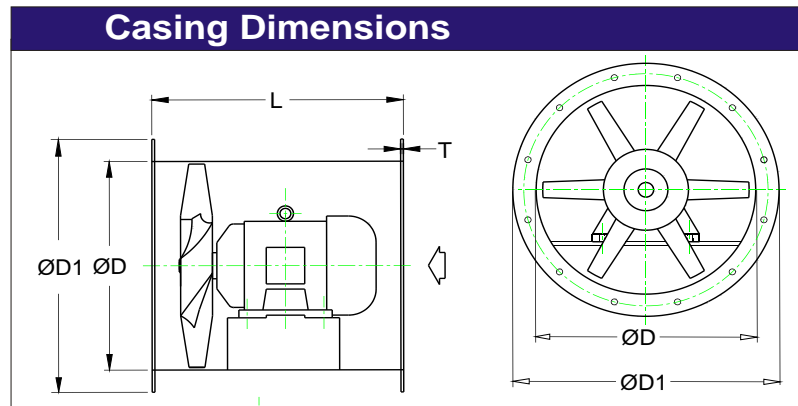

## CASING

The Casing is fabricated from mild steel sheets & plates and fitted with Flanges on both the ends. Fans are available in further shown mounting arrangements.

## IMPELLER

**BKAIR** axial fans have cast aluminium alloy Impellers, having aerodynamical profile that provides high efficiency and low noise. The blades are with fixed and adjustable pitch arrangements.

These are easy in maintenance.



## DRIVING ARRANGEMENTS

BKAIR fans have two types of drive arrangements :-  
The direct drive arrangement and V Belt drive arrangement.

### DIRECT DRIVE

In this arrangement ,impeller and motor both are placed inside the casing and impeller is directly mounted on motor shaft.

### V-BELT DRIVE

In this arrangement ,Impeller is mounted on EN-8 haft coupled with two ball bearings and plummer blocks inside the casing.The motor is mounted on outer surface of the fan casing and shaft is driven with V-Belts.

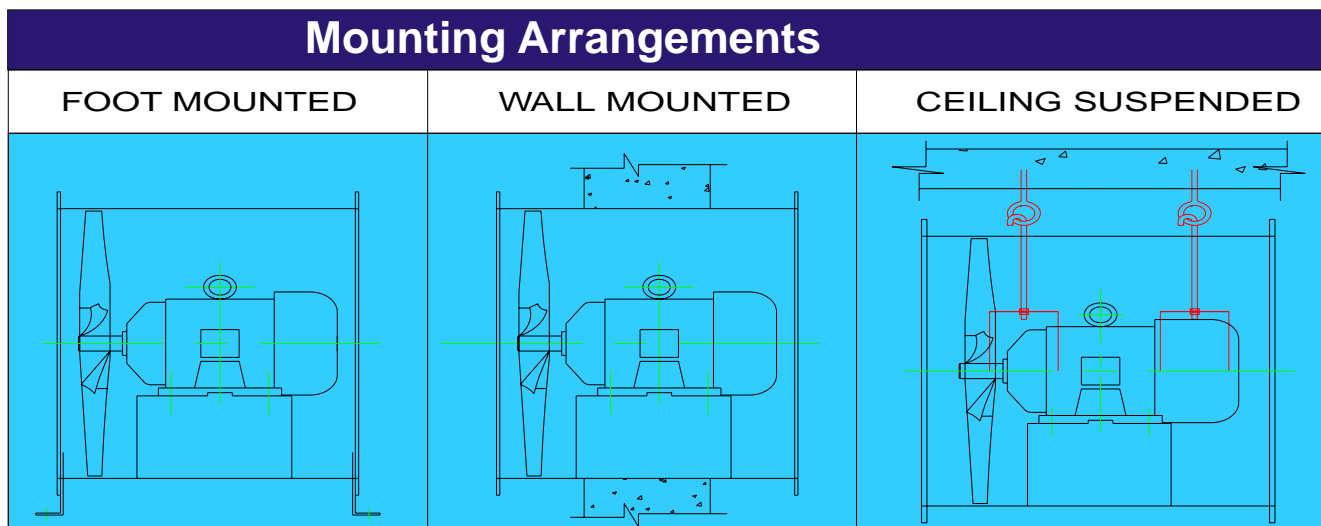

## APPLICATIONS

BKAIR axial fans can be used in -

- General Ventilation
- Fume Exhaust
- Kitchen Exhaust
- As a Roof Extractor
- As a Man cooler
- Air Conditioning & Humidification etc.

# ROOF EXTRACTOR FAN

## ROOF EXTRACTOR

The Roof Extractor is a power driven fan unit and is ideal for extraction through roof.

## CASING

The Casing is fabricated from mild steel sheets & plates and fitted with Flanges on both the ends. The rain cowl is fabricated from G.I. Or FRP.

## IMPELLER

Roof Extractor fans have cast aluminium alloy Impellers, having aerodynamical profile that provides high efficiency and low noise. The blades are with fixed and adjustable pitch arrangements. These are easy in maintenance.



**BKAIR** Roof Extractor fans are manufactured for different industries for extraction through roof, such as- power plants, steel plants, foundaries, industrial buildings, factories etc.

The available sizes are from dia 500 to 1200 mm diameter. The air quantity up to 100000 m<sup>3</sup>/h, Pressure up to 600 Pa.

DIMENSION TABLE					
BKARE	ØC	ØD	A	B	H
500	750	500	190	350	350
600	900	600	270	370	430
700	1050	700	280	466	440
800	1200	800	350	496	560
900	1350	900	365	585	575
1000	1500	1000	365	681	590
1200	1800	1200	390	875	680
1400	2100	1400	460	950	760
1600	2400	1600	475	1050	800

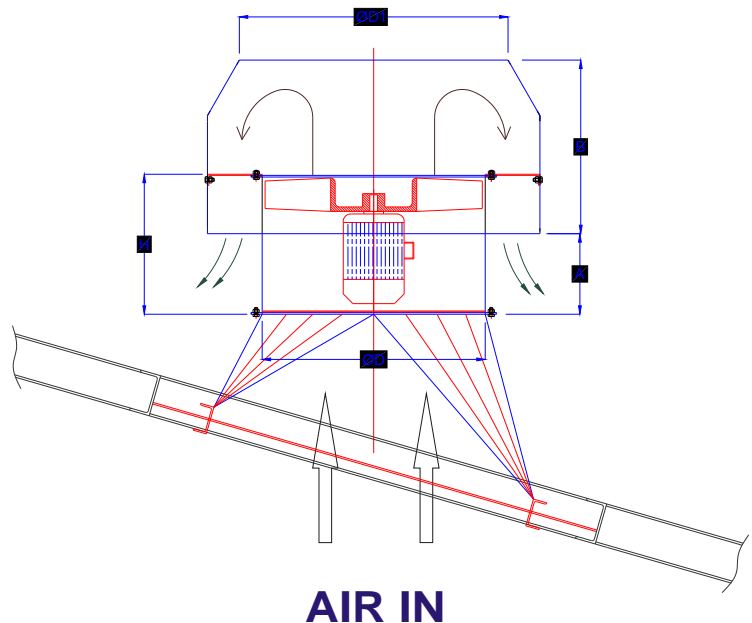

**BKAIR** - A complete solution company with respect to  
DUST, FUME & VENTILATION SYSTEMS

**BKAIR** - Provides turnkey solutions for your DUST, FUME  
& VENTILATION SYSTEMS

**QUALITY POLICY** - BKAIR have a strong faith that customers are the  
focal point of the business and their expectations  
and requirement needs to be understand thoroughly  
and fulfilled in all respect for a prosperous business.

We are committed to achieve customer satisfaction by delivering  
products of right quality at competitive price and on time delivery.

---

**B.K.AIRCOOLING AND VENTILATION SYSTEMS**

Plot no.36,100ft road,Lajpat nagar,NH-2,Mathura(U.P.)

Email: [sales@bkair.co.in](mailto:sales@bkair.co.in), [sales.bkair@gmail.com](mailto:sales.bkair@gmail.com)

Website: [www.bkair.co.in](http://www.bkair.co.in)

Contact : 9897465489, 9953116551

# OTHER RANGE OF PRODUCTS AND SYSTEMS



**Ventilation System**



**Centrifugal Blower**  
With forward curved impeller



**Centrifugal Blower**  
With backward curved impeller



**Air Washer**  
Single Skin/Double Skin



**Fume Scrubbing System**



**Cooling Water Chiller**



**Axial Fan**



**Roof Extractor**



**Dust Collection System**



**Painting Booth**

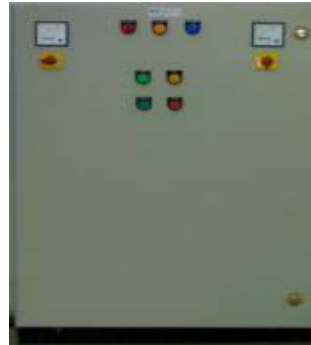

**Electric Panel**



**Humidifier**



**Air Cooling System**



**Cooling Pads**



**Filters**



**Wind Ventilator**

